

TOLSEN FORCE XPRESS

79555-BS ROTARY TOOL KIT

INSTRUCTION MANUAL

230V~50Hz 130W

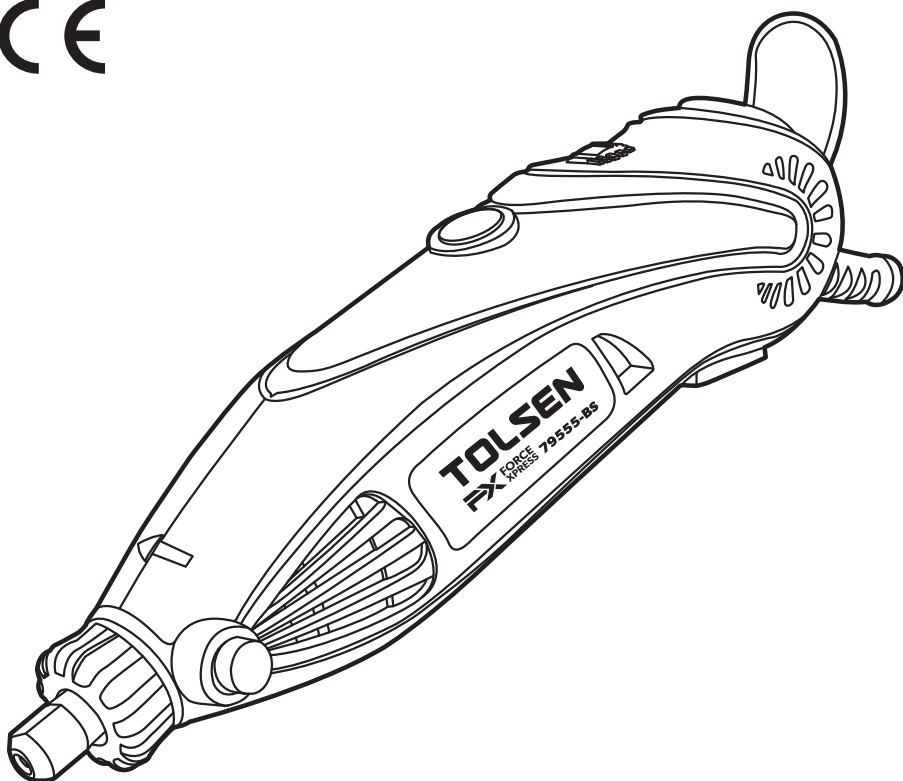

SAVE THIS MANUAL !

You will need this manual for safety instructions, operating procedures and warranty.

Put it and the original sales receipt in a safe dry place for future reference.

IMPORTANT SAFETY INFORMATION

Important! – safety instructions for all tools

WARNING:

When using electric power tools, important safety precautions must always be adhered to in order to reduce the risk of fire, electric shock and personal injury.

PLEASE READ THE FOLLOWING CAREFULLY:

1. **KEEP WORK AREA CLEAN.** Untidy benches and work areas invite injuries.
2. **CONSIDER WORK AREA ENVIRONMENT.** Do not use power tools in damp or wet locations. Do not expose power tools to rain. Keep work areas well lit.
3. **GUARD AGAINST ELECTRIC SHOCK.** Prevent body contact with grounded surfaces. Eg. Radiators, pipes, refrigerator enclosures.
4. **KEEP CHILDREN AWAY.** All visitors must be kept away from the work area. Do not let visitors come into contact with the tool or extension cord.
5. **STORE IDLE TOOLS.** When not in use, tools must be stored in a dry place, out of reach of children.
6. **DO NOT FORCE THE TOOL.** It will do the job in hand better and safer at the rate for which it was intended.
7. **USE THE RIGHT TOOL.** Do not force a small tool to do the job of a heavy duty power tool. Do not use the tool for the purpose it is not intended for
8. **DRESS PROPERLY.** Do not wear loose clothing or jewellery, as these can be caught in moving parts. Gloves and non-skid footwear are recommended when working outdoors. Wear protective head cover to contain long hair.
9. **USE SAFETY GLASSES.** Also use face and dust mask to guard against dust.
10. **DO NOT ABUSE THE CORD.** Never carry the tool by the cord or pull the cord to disconnect the tool. Keep the cord away from heat, oil or sharp objects.
11. **SECURE YOUR WORK.** Use clamps or a vice to hold your work in position. It is much safer than using your hand and it frees both hands to operate the tool.
12. **DO NOT OVERREACH.** Keep proper footing and balance at all times.
13. **MAINTAIN TOOLS WITH CARE.** Keep tools clean for better and safer performance. Follow instructions for lubricating and changing accessories. Keep hands dry, clean and free from oil and grease.
14. **DISCONNECT TOOLS.** When not in use, before servicing and when changing any accessories.
15. **REMOVE ADJUSTING KEYS AND WRENCHES.** Have the habit to check and see that keys and adjusting wrenches are removed from the tool before turning on.
16. **AVOID UNINTENTIONAL STARTING.** Do not carry plugged-in tool with finger on switch. Be sure that the switch is off when plugging in.
17. **OUTDOOR EXTENSION CORDS.** When the tool is used outdoors, only use extension cords intended for use outdoors and so marked.
18. **STAY ALERT.** Watch what you are doing. Use common sense. Do not operate the tool when you are tired.
19. **CHECK DAMAGED PARTS.** Before using the tool, a guard or other part that is damaged, these must be carefully checked to ensure that the tool will perform properly the intended function. Check for alignment of moving parts, binding of moving parts, breakage of parts, mounting and any other condition that may affect the tool's operation.
20. **DO NOT OPERATE** portable electric tools near flammable liquids or in gaseous or explosive atmospheres. Motors in these tools normally spark, and the sparks may ignite fumes.

SETUP

Multifunction power tool use

This rotary tool can be used for drilling, grinding, sanding and polishing, as well as engraving, cutting and removing rust in tight spaces or inaccessible places. The tool can be used on most metals, glass, wood and ceramics. For best performance and results keep the speed as even as possible without exercising too much pressure. As a guideline, use the tool at low speed for all large accessories, such as polishing for example, and at high speed for smaller accessories such as those used for engraving. For grinding and engraving, hold the tool as if it were a pen.

Multifunction power tool start-up

Never start up or stop the tool is the accessory is in contact with the piece to be worked on. Hold it firmly and press the ON/OFF switch. The tool will run continuously until the switch is turned to OFF position. The speed can be adjusted while the tool is running.

Speed adjustment

The multifunction power tool is equipped with speed control. Do not change the speed while the tool is working. The speed switch is located on the rear of the tool. Turn it to increase or reduce speed. Use the tool at low speed for polishing and similar operations, but use higher speed for drilling or cutting action.

Important general safety tips!

1. The Tool should be unplugged when changing accessories.
2. If you stall the tool, switch it off immediately.
3. Periodically check the tightness of your collet chuck, especially during prolonged use of the same accessory
4. After use, always disconnect your power tool
5. Do not undertake repair of the power tool your self.
6. Do not leave your tool unattended while switched on.
7. Do not use or store your tool in damp or wet conditions.

Useful hints & tips

1. Your rotary tool will become warm after prolonged use and so must be switched off and allowed to cool down.
2. To ensure smooth running, the spindle should be oiled periodically.
3. Do not apply too much radial pressure to the accessory bits while polishing, cleaning, sanding or grinding. By doing this you will put a strain on the spindle and adversely affect the precision of the tool.
4. Always work with a sensitive touch so as not to impede the efficiency of your mini tool.
5. When drilling metal, always mark the drilling point with a centre punch first, so that your rotary tool does not slip.
6. Always ensure that you have maximum contact between the accessory shaft and the collet chuck.
7. Vary the speed on the tool for the work in hand, eg. Low speed for polishing & cleaning and high speed for engraving

Placing accessories into the tool

Always switch the tool off first. Hold the locking button at the front of the tool down and undo the collet chuck (anti-clockwise). Insert the collet that matches the shaft size of the accessory to be used. Place the collet nut over the collet and then insert the accessory shaft into the collet chuck ensuring maximum shaft contact. Then tighten up the collet nut. **(DO NOT USE PLIERS)**.

Flexydrive assembly

Remove the front ring nut from the tool by turning in an anti-clockwise direction. Partially unscrew the blocking ring nut from the spindle. Partially extract the internal transmission cable from the flexydrive. Insert the flexydrive transmission cable into the spindle of the tool pushing it in as far as possible. Keep the spindle block button pressed in and screw the spindle blocking ring nut turning it in a clockwise direction. Tighten using the spanner for this purpose. Screw the threaded end of the flexydrive onto the body of the tool and tighten, screwing in a clockwise direction

Changing the insert and accessories on the flexydrive

To change the insert or to install accessories on the flexydrive, follow the same general procedure for insert change and for accessory assembly on the attachment. To block the spindle, turn it until the hole in the shaft is in line with the hole on the handle of the flexydrive. Insert a 1/8" drill bit in the aligned holes to block the shaft.

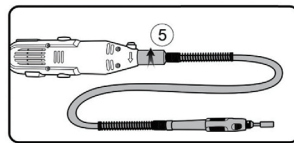
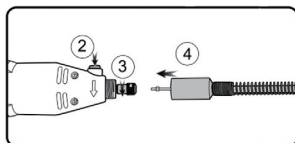
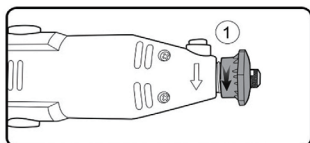

Bench support assembly

It is always advisable to use the bench support when using the flexydrive. Loosen the tightening screw on the vice until the opening is wider than the thickness of the bench top on which the vice will be attached. Set the vice on the edge of the bench top, then tighten the screw until the vice is well fixed on the bench top. Screw the telescopic support onto the body of the vice and pull out to the required length. Hang the tool by its ring located on the rear part of the handle, on the hook on the telescopic support. The vice can be attached in a permanent stable manner to the bench top using two threaded screws.

SPECIFICATIONS

Available Voltages	230V, 50Hz
Amperage rating	135W
No Load Speed	8000 - 38,000 /min
Collet chuck capacity	max 3.2mm



CE DECLARATION OF CONFORMITY

WE
SUZHOU TOLSEN TOOLS CO.,LTD.
Building No.2, Zhenxing Road, Hexing, Jinfeng Town,
Zhangjiagang City, Jiangsu Province, China

Declare that the product
79555 Mini-Grinder
Serial number: N/A

Complies with the essential health and safety requirements
of the following Directices:
EC Machinery Directive 2006/42/EC
The EMC Directive 2014/30/EU

Standards and technical specifications referred to:
EN 60745-1:2009+A11:2010
EN 60745-2-23:2013
EN 55014-1:2006/+A1:2009/+A2:2011
EN 55014-2:2015
EN 61000-3-2:2014
EN 61000-3-3:2013

Authorised Signatory and technical file holder
Signed for and on behalf of:
SUZHOU TOLSEN TOOLS CO.,LTD.
Building No.2, Zhenxing Road, Hexing, Jinfeng Town,
Zhangjiagang City, Jiangsu Province, China
ZHANG XING YU
Group Quality Director

on:26/05/2020

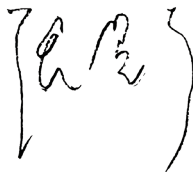

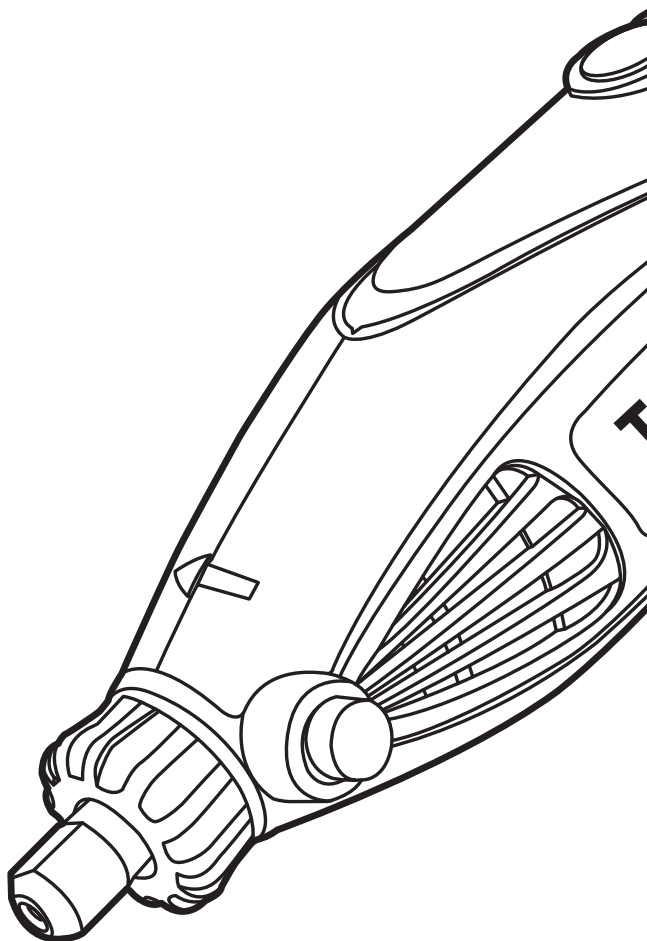

SUZHOU TOLSEN
TOOLS CO.,LTD.

www.tolsentools.com

TOLSEN is a trademark or
registered trademark of TOLSEN
TOOLS. All rights reserved.
MADE IN CHINA

