

# TOLSEN

## 10500 DRILL STAND

INSTRUCTION MANUAL

43mm

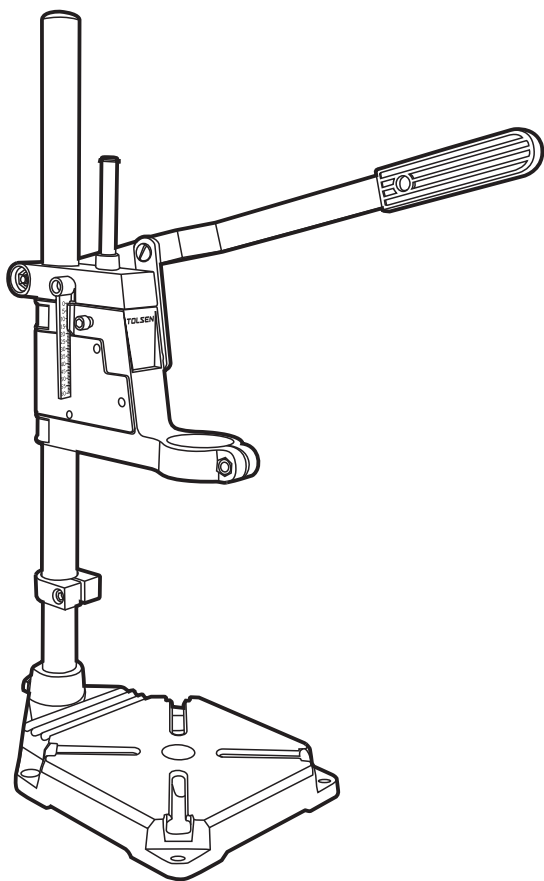

### SAVE THIS MANUAL !

You will need this manual for safety instructions, operating procedures and warranty.  
Put it and the original sales receipt in a safe dry place for future reference.

# TOLSEN

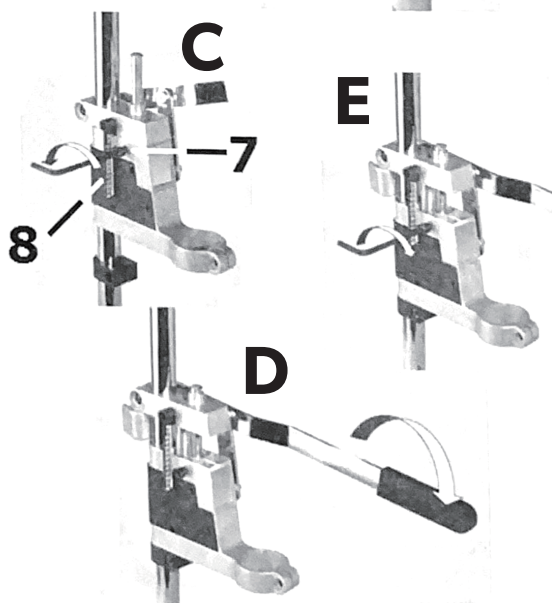
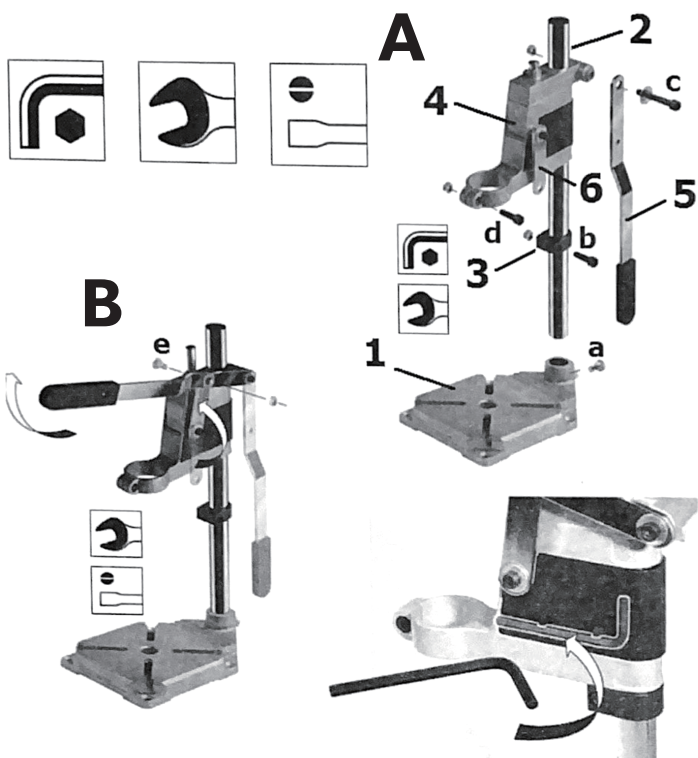







WPST		
a	Ø7.64x21mm	
b	Ø5.8x30mm	
c	Ø5.8x50mm	
d	Ø5.8x25mm	
e	Ø5.8x16mm	

## Introduction

Please read the manual thoroughly before bringing this device into service. If the device was damaged in transit, do not install or use it and contact your dealer. Damage caused by disregard of certain guidelines in this manual is not covered by the warranty and the dealer will not accept responsibility for any ensuing defects or problems.

## Safety Instructions

	Keep away from children and unauthorised users.
	Always wear protective gloves during use.
	Always wear a suitable dust mask during use.
	Always wear protective eyeglasses during use.
	Do not use in an explosive atmosphere.
	The drill bit and work piece may become extremely hot. Do not touch with bare hands.

## General Guidelines

1. Protect this device from shocks and abuse.
2. Protect the device against extreme heat, dust and moisture.
3. Familiarise yourself with the functions of the device before actually using it.
4. All modifications of the device are forbidden for safety reasons.
5. Only use the device for its intended purpose. Using the device in an unauthorised way will void the warranty.
6. Damage to drills, drill bits, work pieces or any personal injury resulting from the use of this device is not covered by the warranty.

## Features

1. Base with holes for secure bench mounting
2. For drills with 43mm collar.
3. Adjustable drill depth with rule and stop

## Overview

Refer to the illustrations on page 2 of this manual.

1	base	5	lever
2	column	6	lever support
3	stop	7	preset bolt
4	drill holder	8	ruler

## ASSEMBLY

1. Insert the column [2] into the base [1] and tighten it securely with the screw(s) [a].
2. Slide the stop [3] over the column.
3. Slide the drill holder [4] over the column [2].
4. Slide the washer and lever [5] over the bolt and use this to secure the drill holder [4] to the column [2]. Use the included hex key.
5. Lift the lever [5] and the lever support [6]. Align the holes and insert the bolt [e]. Note: the bolt must be inserted at the side of the lever support [6].
6. Place a washer over the bolt [e] and tighten the lock nut..
7. The drill holder [4] has a provision to store the hex key.

# TOLSEN

## Use

1. Inspect the drill stand for signs of damage before every use. When damage is noticed, do not use it. Contact your local dealer for repair and/or spare parts.
2. Keep the working area clean at all times.
3. Place the drill stand on a flat and steady surface capable of carrying the weight of the stand and the work piece. Do not use on slopes etc.
4. For security reasons, it is highly recommended to attach the drill stand to the work bench. Screw 4 screws (not incl.) through the 4 corners of the base [1]. Mark the location of the holes on the work piece. Place a drill (not incl.) with the desired drill bit (not incl.) in the drill holder [4] and tighten the bolt [d] and nut. When necessary, use the included plastic reduction ring. Hold the drill holder [4] with one hand to avoid that it slides down possibly causing damage to the drill bit when it hits the base [1]. Do not switch on the drill yet. Pull down the lever [5] and slide down the drill holder until the tip of the drill bit almost touches the base [1]. Slide the stop [3] upwards until it touches the drill holder [4] and secure it tightly with bolt [b]. This prevents that the drill bit accidentally hits the base during drilling. Place the work piece on the base [1], align the drill bit with a hole marking and secure the work piece in such a way that it can not accidentally move during drilling (securing equipment not included). Note: Make sure the drill is always above the base [1] when drilling holes. Lower the drill holder [4] until the tip of the drill bit almost touches the work piece. Tighten the drill holder [4] securely with bolt [c]. Make sure all bolts are securely tightened before proceeding! Switch on the drill. When the drill is at full speed, gently pull down the lever [5]. Depending on the material of the work piece and the diameter of the drill bit, apply some cooling liquid (not incl.) on the drill bit. When the desired depth is reached (see ruler [8]), gently lift the lever [5] until the drill bit is completely out of the hole. Never let go off the lever as this will cause damage to the mechanism. Switch off the drill and wait until the drill bit comes to a full stop before handling the work piece. When multiple holes of the same depth are required, use the preset stop. Release the preset bolt [7] on the side of the drill holder [4]. Refer to illustration [C]. Drill the hole as described before. When the desired depth is reached, tighten the preset bolt [7]. For the following holes, simply pull down the lever [5] until it will not move any further.

## Technical specifications

Column height	510mm
Column diameter	25mm
Depth of feed	60mm
Collar diameter	43mm
Base size	22x16cm
Net weight	3kg

Use this device with original accessories only. TOLSEN cannot be held responsible in the event of damage or injury resulted from (incorrect) use of this device. For more info concerning this product, please visit our website [www.tolsentools.com](http://www.tolsentools.com). The information in this manual is subject to change without prior notice.

SUZHOU TOLSEN  
TOOLS CO., LTD.

[www.tolsentools.com](http://www.tolsentools.com)  
MADE IN CHINA

