

TOLSEN

63111/63112/63113 PALLET TRUCK

INSTRUCTION MANUAL

2T/2.5T/3T

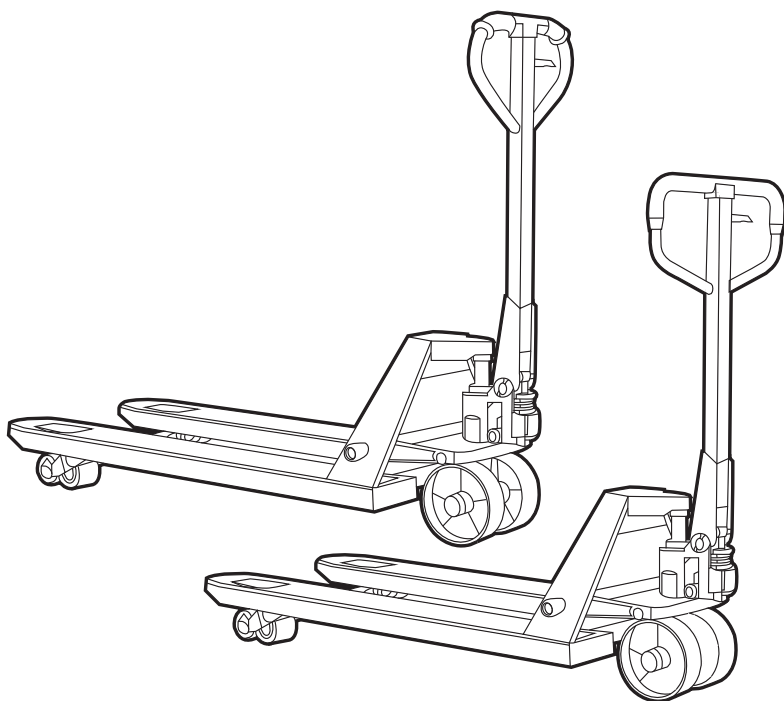

SAVE THIS MANUAL !

To reduce the risk of injury, all operators and maintenance personnel must read and understand these instructions before operating, changing accessories or performing maintenance on equipment we produced. All possible situations cannot be covered in these instructions. Care must be exercised by everyone using, maintaining or work near this equipment.

Introduction

Before attempting to use your hydraulic pallet truck, we recommend you read this manual and familiarize yourself with the details of operation.

Safety Instructions

1. Keep feet out from underneath load.
2. Balance load securely before moving it.
3. Don't load pallet truck beyond capacity.

Assembling Pallet Truck

To attach hydraulic unit to fork :

1. Insert hydraulic ram into fork frame ram socket.
2. Line up hydraulic table with holes in lifting yoke. See Figure 1.

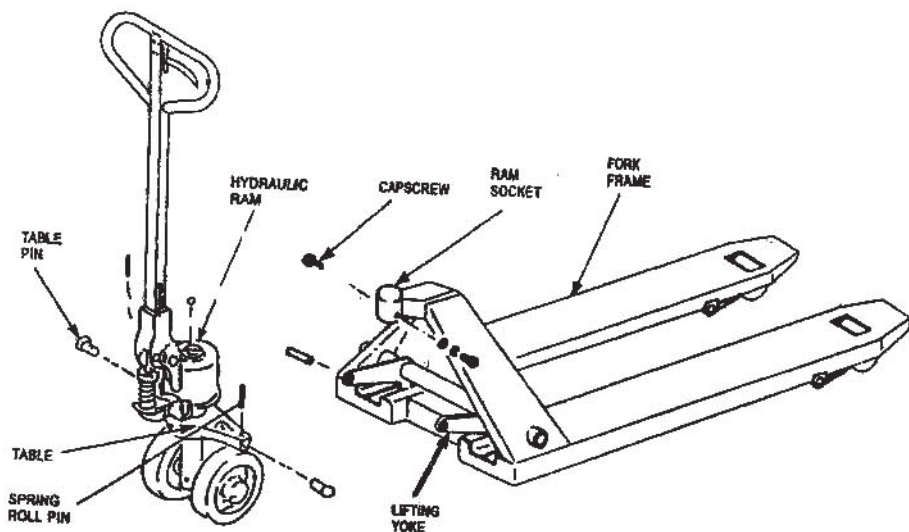

FIGURE 1
PTA

3. Insert table pins back into lifting yoke slots.
4. Line up each hole in table with holes in each table pin.
5. Insert each spring roll through table top and into hole in table pin.
6. Insert caps crews into sides of fork frame cam socket. Hydraulic unit is now assembled to fork frame.

Operating Pallet Truck

To raise fork, place handle lever in Up position (bottom part of handle slot)
See Figure 2.

To lower fork, pull lever to DOWN position (upper part of slot).

To freely move handle, set lever in NEUTRAL (center notch of slot).

To lift load:

1. Lower fork to lowest position.
2. Insert fork under load.
3. Place lever in UP position (bottom part of slot).
4. Pump handle until fork reaches desired height.

To move load:

1. Place lever in NEUTRAL Position (center notch of slot).
2. Pull or push load to desired location.

To lower load:

1. Pull lever to DOWN position (upper part of slot).

NOTE: Load is now down.

2. Pull fork away from load.

Adjusting Up-Down Cam

To adjust cam, set lever in NEUTRAL position, and turn cam nut while pumping handle.
(See Figure 3-) When no longer lifting, turn nut once again.

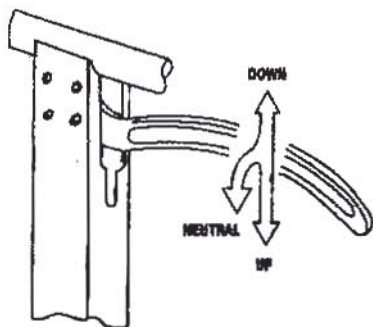

FIGURE 2

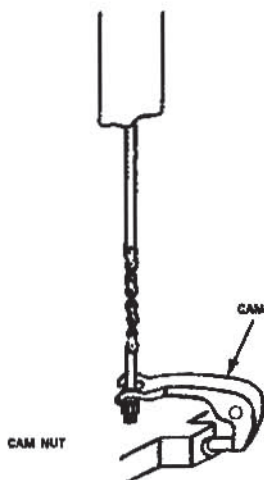

FIGURE 3

Cleaning Relief Valve

Over time, relief valve may become clogged with debris and will not work properly. To clean relief valve, flush out hydraulic system as follows: Pump handle quickly. Raising pallet truck to full extent. Then quickly release pumping action.

Lubrication and Oiling

When changing or adding oil, fill tank to 80% capacity (Figure 4) with hydraulic oil, such as:
 Shell Tellus Oil.....No.22 or 27
 Turbine Oil.....No.22
 Texaco Regal.....No.32

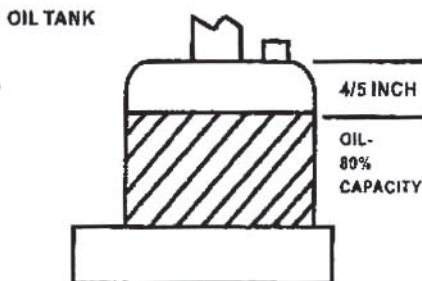

FIGURE 4

Check oil level annually.

Change grease of rear and front wheels annually.

Troubleshooting

Possible problems could arise in the operation of your hydraulic pallet truck. Their probable cause(s) and corrective action(s) follow:

Condition	Probable Cause	Corrective Action
Hydraulic unit does not lift.	Oil low in tank	Make sure of no oil leakage from valve, and add oil.
	Steel ball not seated in hydraulic unit	See "Cleaning Relief Valve" in this manual.
Once lifted, Truck lowers by itself.	Worn o-ring in cylinder	Consult authorized repair station.
	Steel ball not seated in hydraulic unit	See "Cleaning Relief Valve" in this manual.
	Worn o-ring in ram cylinder	See "Cleaning Relief Valve" in this manual.
	Relief valve not seated properly Relief valve not adjusted properly	See "Cleaning Relief Valve" in this manual. Reload truck within load capacity and adjust valve by pressure adjustment screw.
Fork does not lower.	Oil leakage from each valve cam broken	Tighten plug of each valve
	Up-down cam nut out of adjustment	Refer to "Adjusting Up-Down Cam" in this manual
	Replace broken parts	
Lever does not set at NEUTRAL position.	Broken fork rods and linkage	Refer to "Adjusting Up-Down Cam" in this manual
	Up-down cam nut out of adjustment.	

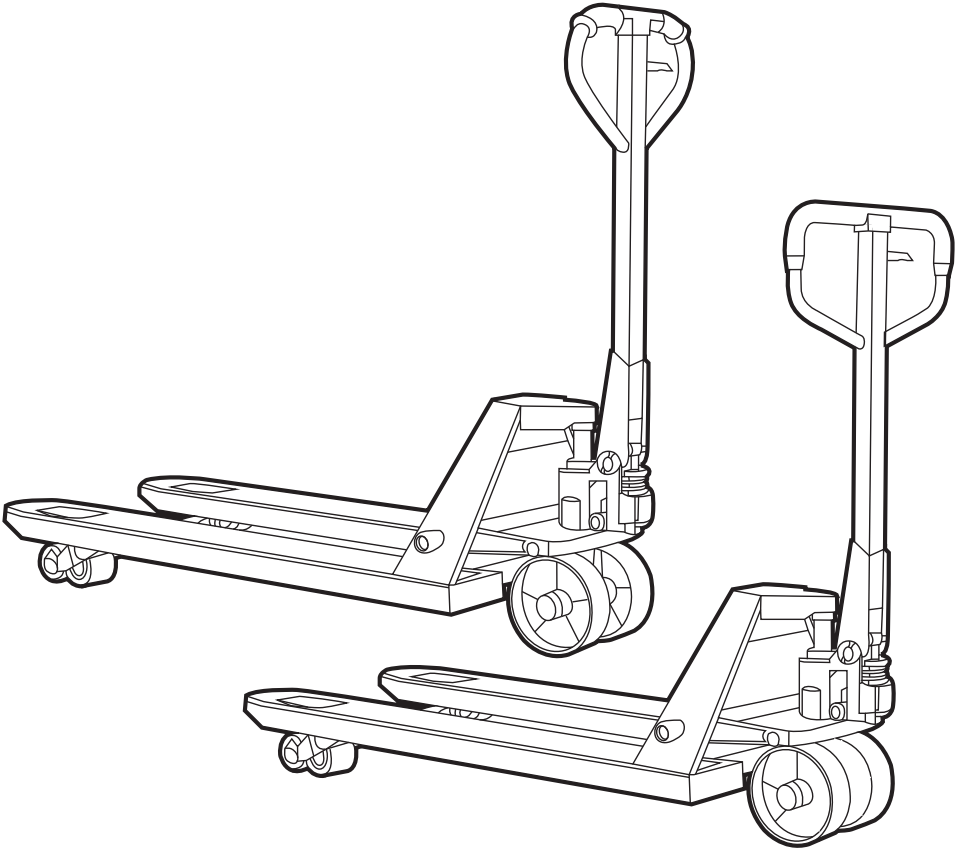

**SUZHOU TOLSEN
TOOLS CO.,LTD.**

www.tolseentools.com

TOLSEN is a trademark or
registered trademark of TOLSEN
TOOLS. All rights reserved.
MADE IN CHINA



SCAN TO VISIT
PRODUCT LINK
63111/63112



SCAN TO VISIT
PRODUCT LINK
63113